



INDICATOR

Want to know exactly when to change your filter?
Visit phoxwater.com/app to get your indicator!

ACTIVATE YOUR GUARANTEE

Visit phoxwater.com/activate to
activate your 12 month parts guarantee



NEED HELP?

service@phoxwater.com

HOW TO REACTIVATE AFTER A PERIOD OF NON-USE:

Soak in water during non-use and
perform 2 run throughs before
commencing use.

Household equipment for the treatment of drinking water. The pitcher filters the drinking water from the mains thanks to a cartridge that improves the taste of the water by reducing any unwanted substances that may be present.

Warning: this product requires regular periodic maintenance, including washing the jug and replacing the filter, in order to ensure the potability requirements of the treated drinking water and the maintenance of improvements as declared by the manufacturer.

phox

HOW TO SET UP YOUR MAXTRA+ COMPATIBLE CARTRIDGE



1 Start with a clean, empty cartridge.

2 Open up the cartridge by pulling a thumb tab away from the cartridge and lifting the lid out in the opposite direction. Remove felt tray.

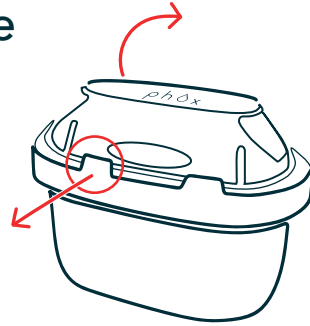

3 Open refill pack & pour into the cartridge.

4 Take out the carbon felt disk & insert into lid/felt tray as shown.

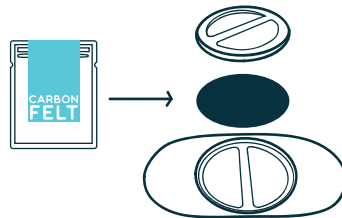

5 Wipe inside rim of cartridge to allow clean connection with felt tray.

6 Click the felt tray back into the cartridge.

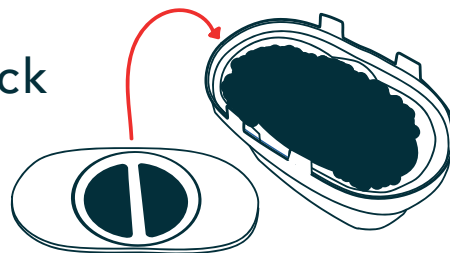

7 Fit the lid securely on to the cartridge. Make sure all 6 teeth are showing above the lid.

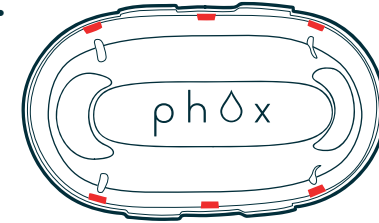

Soak the cartridge in fresh cold water for 6 minutes.

8 Place the cartridge into the reservoir and fill up. Allow 2 full reservoirs to filter before consuming water.

YOU ARE NOW READY TO GO!



SCAN FOR SET UP VIDEO

OR HEAD TO
[PHOXWATER.COM/SETUP](https://phoxwater.com/setup)



@PHOXWATER
PHOXWATER.COM